

CARGO BUILDING WITH COLD STORAGE & OFFICE AVAILABLE at Toledo Express Airport

www.toledoportauthority.org/coldcargo



STREET SIDE ACCESS



AIRFIELD SIDE ACCESS



COLD STORAGE

FEATURES

- 8,407 square feet of space available – Partial leasing of building is available
- 4,405 square feet of cold storage available
- 4,002 square feet of warehouse available
- Warehouse is currently divided but can be adjusted based on space requirements.
- Multiple airfield & street side doors on both facilities accommodate traditional semi-trailer loading
- Adjacent office space available
- Ample parking
- Facility is in move-in condition

Toledo Express Airport is conveniently located in Swanton, Ohio and is home to the 180th Air National Guard and several aviation operations. Toledo Express has direct access to the Ohio Turnpike and Interstate 475/23.

CONTACT US

For more information contact **Matt Sapara** at the **Toledo-Lucas County Port Authority**
Phone: 419.243.8251 | Mobile: 419.260.9994
msapara@toledoportauthority.org

A One Maritime Plaza | Toledo, OH 43604
T 419 243 8251 F 419 243 1835
W www.toledoportauthority.org



CARGO BUILDING WITH COLD STORAGE & OFFICE AVAILABLE

at Toledo Express Airport

www.toledoportauthority.org/coldcargo

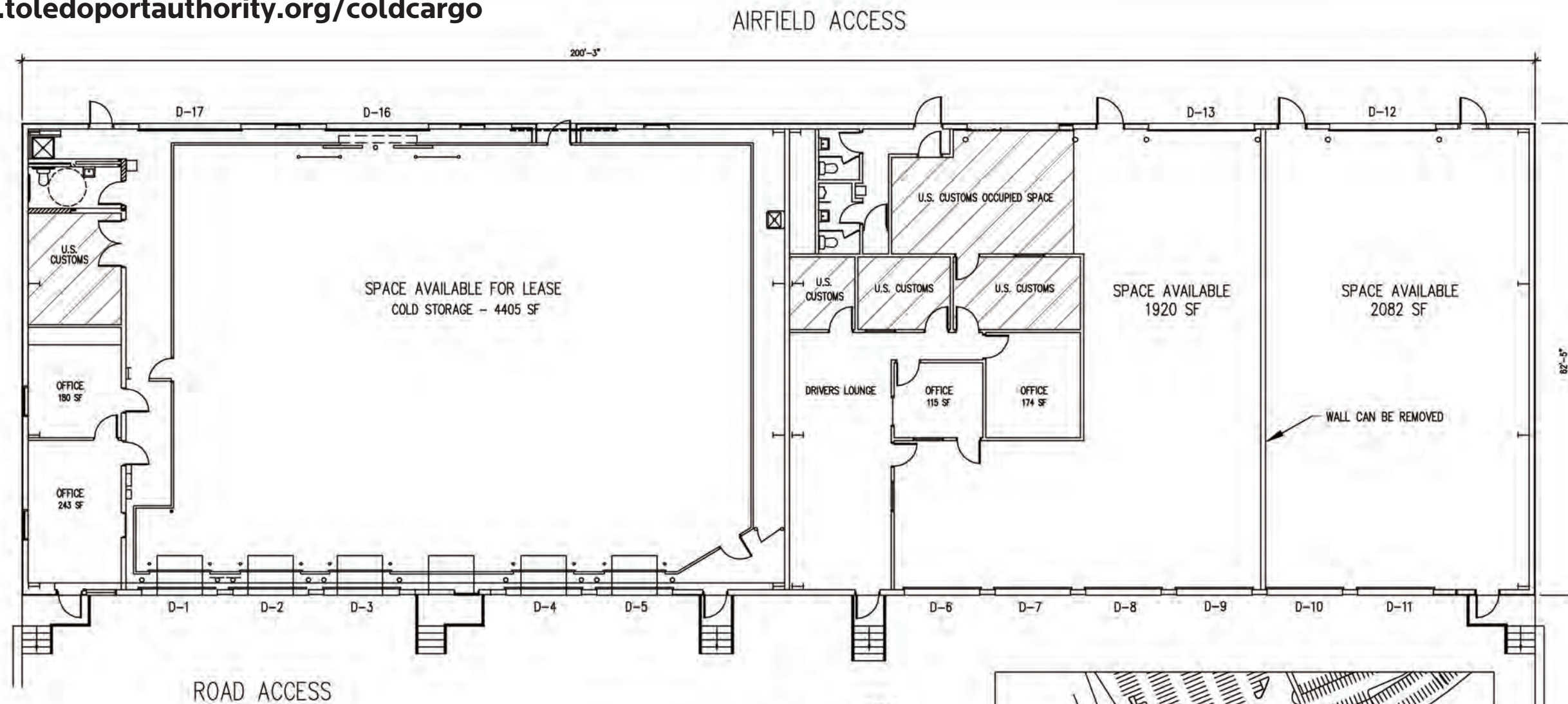

CARGO BUILDING PLAN
NTS



DOOR SCHEDULE							
DOOR No.	EXT. DOOR SIZE			INT. DOOR SIZE			REMARKS
	W	H	T	W	H	T	
D-1	9'-6"	11'-6"	--	8'-0"	8'-0"	--	COOLER ENTRANCE
D-2	9'-6"	11'-6"	--	8'-0"	8'-0"	--	COOLER ENTRANCE
D-3	9'-6"	11'-6"	--	8'-0"	8'-0"	--	COOLER ENTRANCE
D-4	9'-6"	11'-6"	--	8'-0"	8'-0"	--	COOLER ENTRANCE
D-5	9'-6"	11'-6"	--	8'-0"	8'-0"	--	COOLER ENTRANCE
D-6	9'-6"	12'-0"	--	--	--	--	
D-7	9'-6"	12'-0"	--	--	--	--	
D-8	9'-6"	12'-0"	--	--	--	--	
D-9	9'-6"	12'-0"	--	--	--	--	
D-10	9'-6"	12'-0"	--	--	--	--	
D-11	9'-6"	12'-0"	--	--	--	--	
D-12	13'-6"	12'-0"	--	--	--	--	
D-13	13'-6"	13'-10"	--	--	--	--	
D-16	13'-6"	14'-0"	--	8'-0"	8'-0"	--	COOLER ENTRANCE
D-17	13'-6"	14'-0"	--	--	--	--	

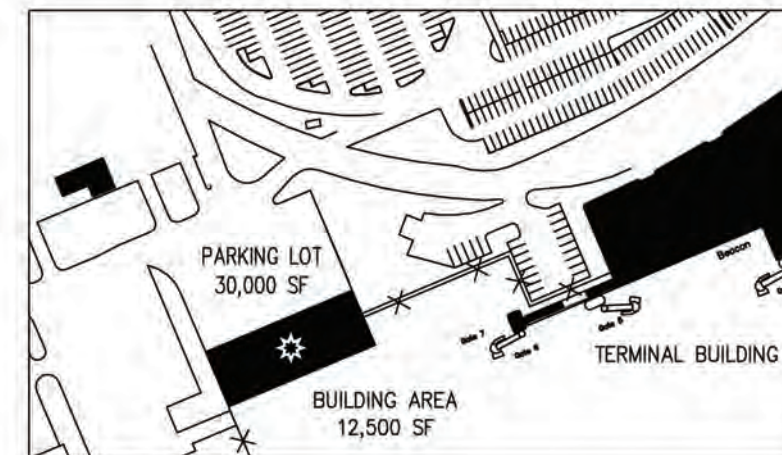

SITE PLAN
NTS



TOLEDO-LUCAS COUNTY PORT AUTHORITY			
REVISIONS			
NO.	DATE	REMARKS	BY

TOLEDO EXPRESS AIRPORT	
CGL / CARGO BUILDING FLOOR PLAN	DESIGNED
	DRAWN
	CHECKED
	APPROVED